

KEY TO CODES

CYL	1 2 1	3	3 2	0 0 5 0	C	P	F1
	TYPE		BORE	STROKE	MATERIAL	GASKETS	END-OF-STROKE STOP
	121 Double-acting cushioned ● 122 Through-rod 124 Double-acting, non-cushioned	3 Series 3 ◆ 4 Series 3 No stick-slip 5 Series 3 Non-magnetic	▲ 32 = Ø 32 40 = Ø 40 50 = Ø 50 63 = Ø 63 80 = Ø 80 A1 = Ø 100	For the maximum suppliable strokes, look at the technical data	A C45 chromed piston rod, aluminium piston: standard for all cylinders with ≥ 1000 mm-stroke cylinders and for cylinder with Ø 80 mm and over C C45 chromed piston rod, technopolymer piston: standard for cylinders of Ø 32 to 63 mm with <1000 mm strokes Z Stainless steel piston rod and nut aluminium piston X Stainless steel piston rod and nut technopolymer piston	N NBR gaskets P Polyurethane gaskets V FKM/FPM gaskets ● B Low temperature	● F1 Extended piston rod F2 Retracting piston rod ● F3 Retracting piston rod and extended piston rod

- Only available for versions with aluminium piston (A or Z)
- ◆ For speeds lower than 0.2 m/s, to prevent surging. Use no-lubricated air only

- ▲ Regarding the Ø32 cylinders, the heads with end-of-stroke stop hasn't the pneumatic cushioning

ACCESSORIES

All the accessories of ISO 15552 cylinders (page A1.46) can be used, **except for the guide units (GDS, GDH, GDM)** since the protrusion of the locking piston interferes with the guide unit.

NB: The screws used to secure the accessory to the heads fitted with a stop must be longer than those supplied together with the accessories. The screw length is calculated by summing up the catalogue-specified thickness of the accessory flange and the BG1 dimension, rounding down to -3 mm.

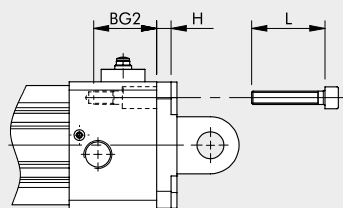

$$L = BG2 + H - (0 - 3) \text{ mm}$$

NOTES